

Product notes

Clip X LED wall light. A small and discreet, floorwasher providing a warm light.

This Italian made fitting has a fixed optic set in an anti dust housing. Suitable for internal or external use.

Brass body. Available in a White, Grey, Chrome or Steel finishes, a 70° beam angle and a choice of light output colours.

Suitable for various wall light applications including kitchens and bathrooms and ideal for providing a wash of light to steps.

Supplied with retaining spring for false ceilings.



Cut-out	29mm diameter	Available finishes	Codes
Wattage	2 watts	White	JR07019
CRI	80	Steel	JR07016
Lumens	Cool white 253, Natural white 222, Warm white 208		
Wiring	Series		
Driver mA (not included)	630mA		
Dimmable	Yes 1-10v or DMX	Available output colours	
IP rating	IP66	Cold White	C
Class	III – EN605981 Compliant	Natural White	N
		Warm White	W

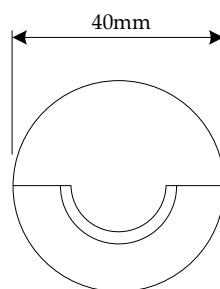
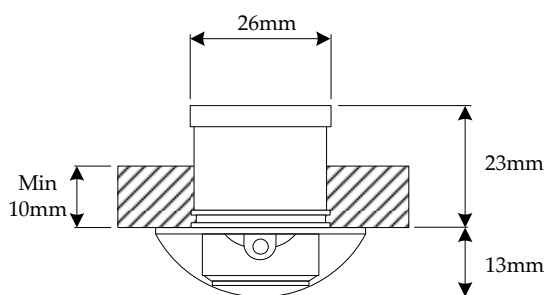

Available beam angles 70°

To order this product:

Use the product Finish Colour Code followed by the Output Colour and Beam Angle. For example to order a Steel fitting with a Warm White light output and a 70° beam angle use: JR07016-W-70